

**SEGMENTED HALF DOME SKYLIGHTS &  
STRECHFORMED DOME SKYLIGHTS  
1000 SERIES  
UP TO 4' RAFTER SPAN 2' OC.**

**Sky-Tech Glazing Systems, LLC.**

Mailing Address: 160 W. Foothill PKWY Suit 105 #212, Corona, CA 92882  
Physical Address: 402 E. Princeland Court, Suite 5, Corona, CA 92879

**800-440-9999 fax : 909-606-1441**

E-mail: [info@sky-techglazing.com](mailto:info@sky-techglazing.com)  
Visit Us At [www.sky-techglazing.com](http://www.sky-techglazing.com)

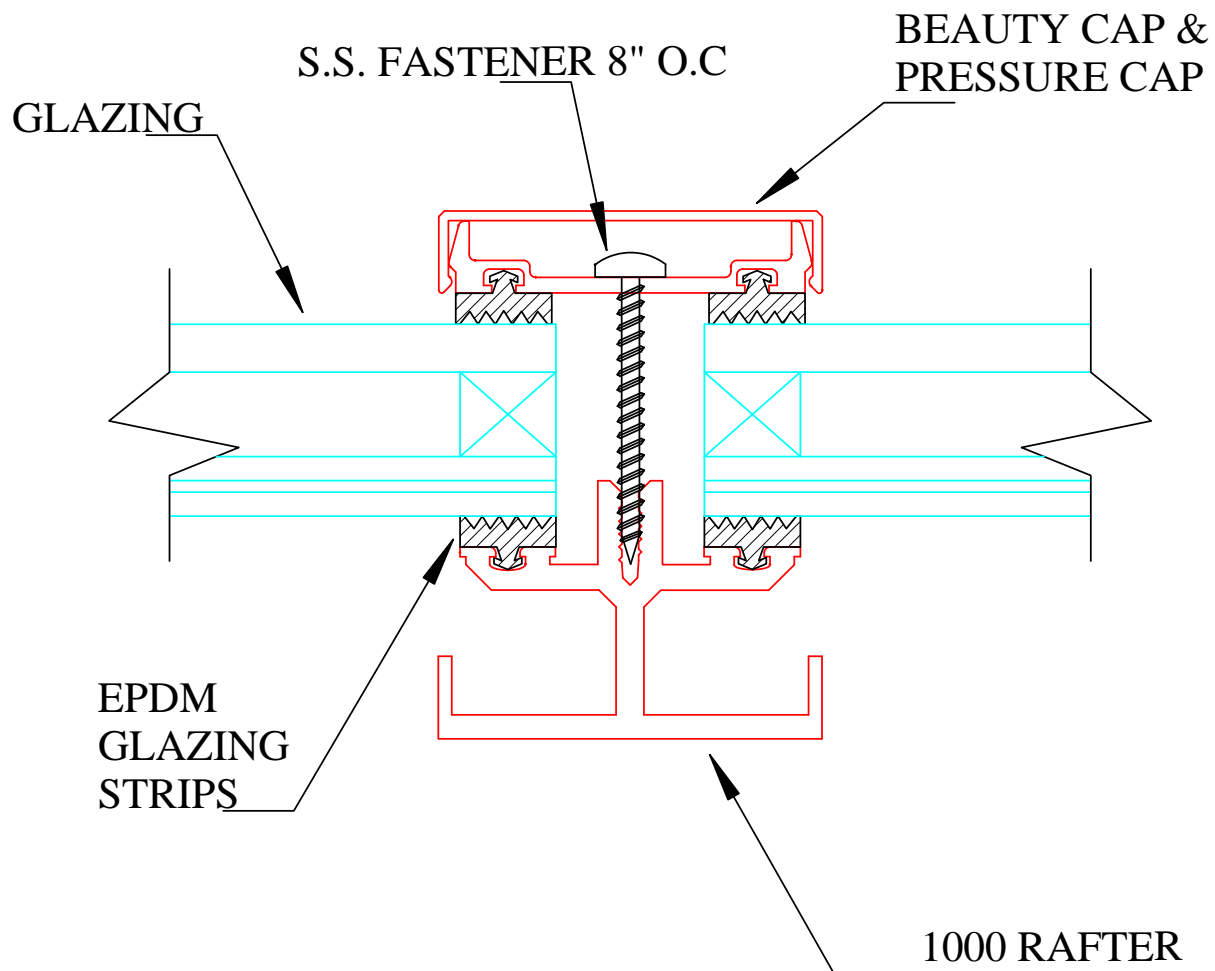

# B3

## 1000 Vertical Rafter Detail

1" = 1"

Sky-Tech Glazing Systems, LLC.

Mailing Address: 160 W. Foothill PKWY Suit 105 #212, Corona, CA 92882  
Physical Address: 402 E. Princeland Court, Suite 5, Corona, CA 92879

800-440-9999 fax : 909-606-1441

E-mail: [info@sky-techglazing.com](mailto:info@sky-techglazing.com)  
Visit Us At [www.sky-techglazing.com](http://www.sky-techglazing.com)

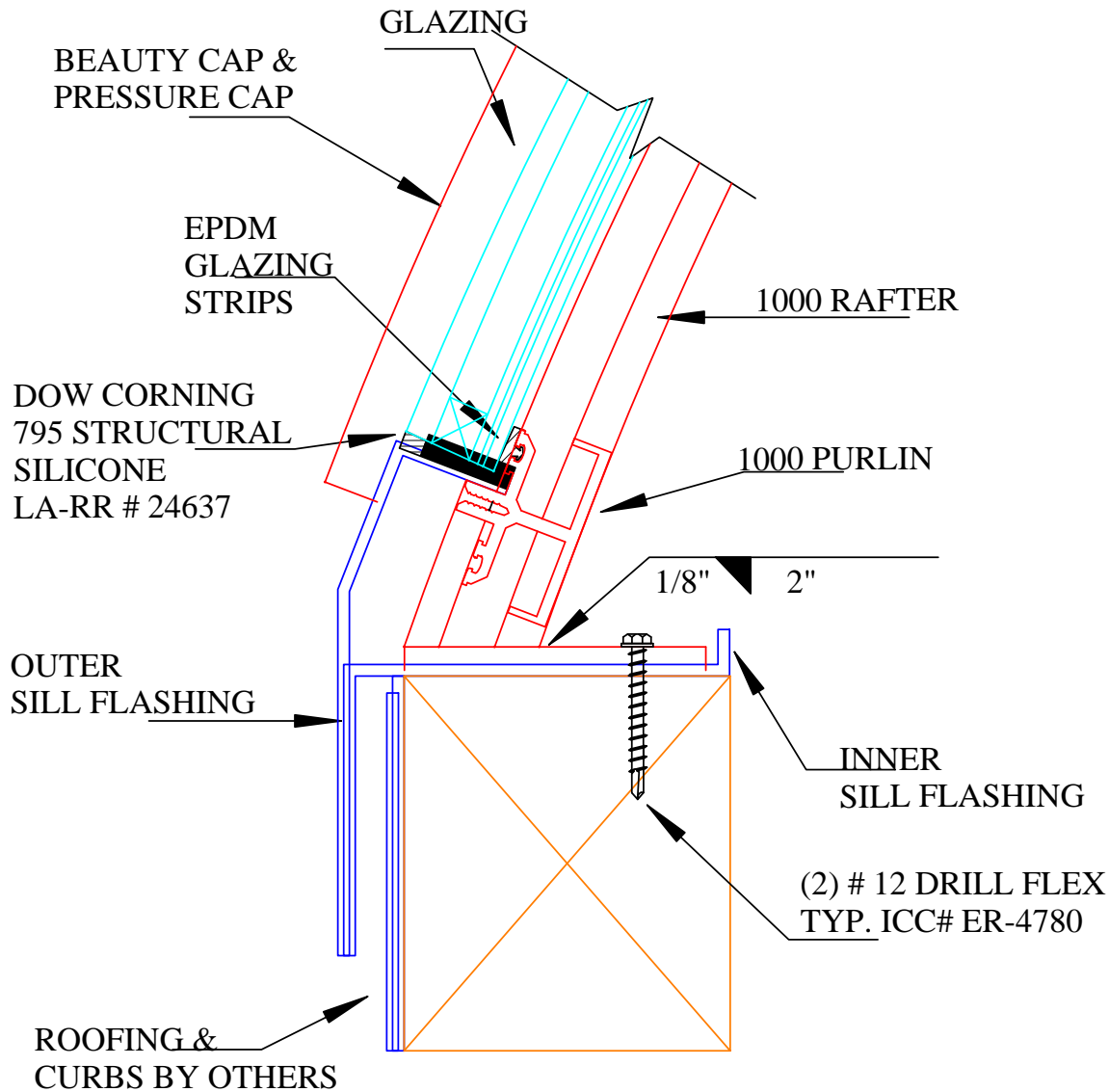

# B7

## 1000 Stretched Formed Sill Detail

1/2" = 1"

Sky-Tech Glazing Systems, LLC.

800-440-9999 fax : 909-606-1441

Mailing Address: 160 W. Foothill PKWY Suit 105 #212, Corona, CA 92882  
Physical Address: 402 E. Princeland Court, Suite 5, Corona, CA 92879

E-mail: [info@sky-techglazing.com](mailto:info@sky-techglazing.com)  
Visit Us At [www.sky-techglazing.com](http://www.sky-techglazing.com)

## Cut View

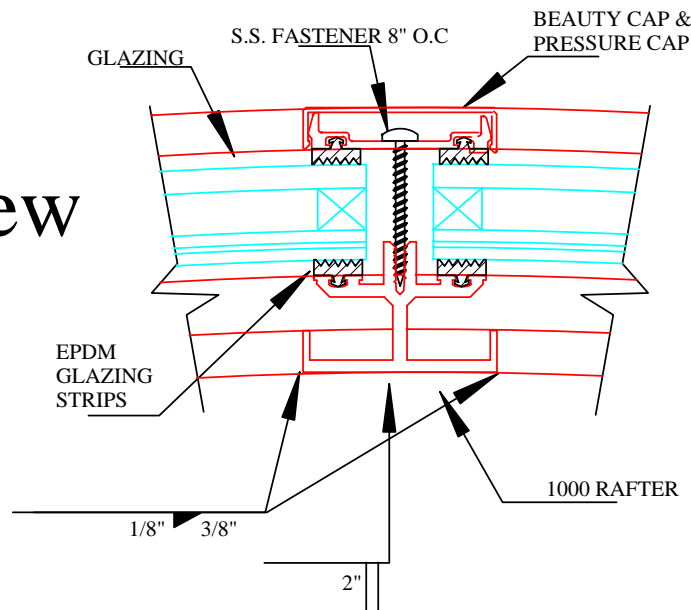

## Bottom View

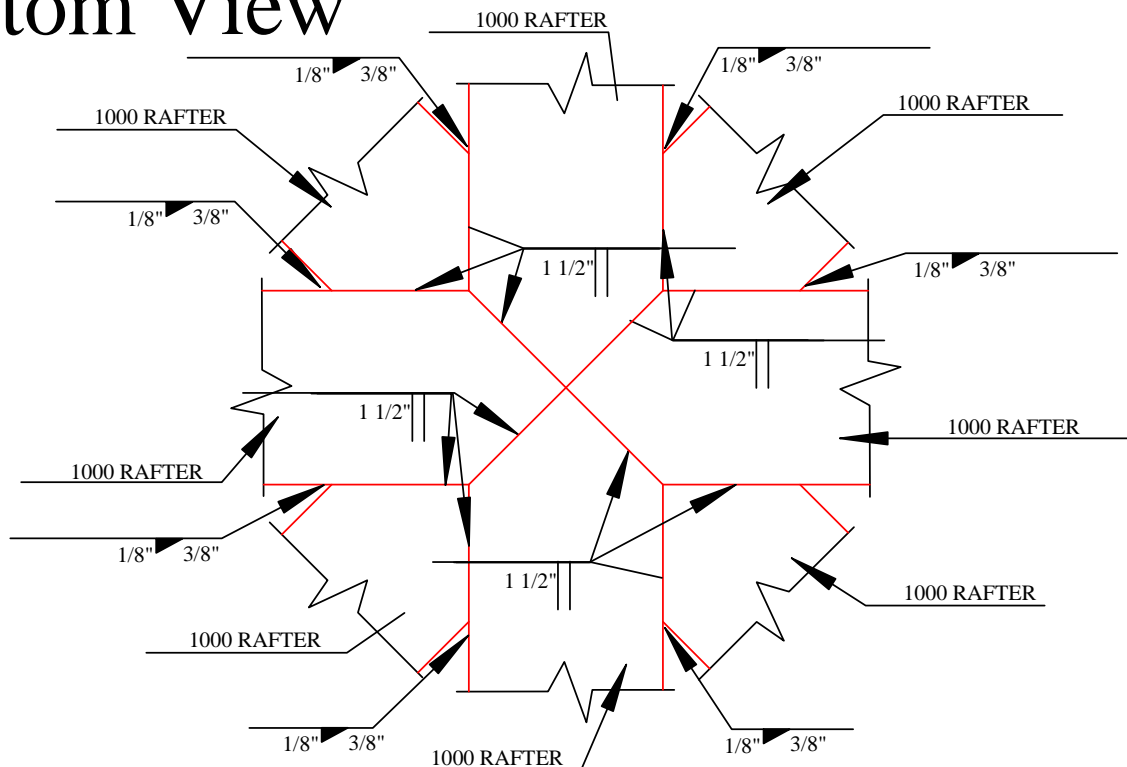

**Q**

## 1000 Stretched Formed Apex Detail

1/2" = 1"

Sky-Tech Glazing Systems, LLC.

Mailing Address: 160 W. Foothill PKWY Suit 105 #212, Corona, CA 92882  
Physical Address: 402 E. Princland Court, Suite 5, Corona, CA 92879

800-440-9999 fax : 909-606-1441

E-mail: [info@sky-techglazing.com](mailto:info@sky-techglazing.com)  
Visit Us At [www.sky-techglazing.com](http://www.sky-techglazing.com)